

MultiStation



Add Multiple Users

Fully automatic KVM sharing on first-come first-serve basis

Use for point-of-sale, office collaboration, production floor, conference room, and many others

Security features

Features and Benefits

- Fully automatic KVM sharing on first-come first-serve basis
- Available in three models:
 - ML-2U - Standalone unit 1 KVM and 1 CPU
 - ML-4U - Standalone unit 4 KVMs and 1 CPU
 - MLK-2U - Distributed units up to 250 feet apart Local unit with 1 KVM and 1 CPU Remote unit with 1 KVM
- Adjustable keyboard timeout, video blanking timeout, keyboard typematic rate and delay on each station
- Dip switches allow commands to be disabled on each KVM
- Can display video to all KVMs simultaneously
- Enable, disable, and freeze commands to control access of stations
- Automatic enable of PS/2 mouse when cable is reconnected
- Drives keyboard, video, and mouse signals up to 100 feet away
- Video resolution supports VGA up to 1280X1024 non-interlaced video
- Status LED on front panel flashes to show on-line status and keyboard-mouse activity
- Supports both PS/2 and serial mouse and PC keyboard modes 1, 2, and 3

The MultiStation™ Advantage...

When you need to access one computer from multiple locations, MultiStation™ is the product for you. The MultiStation allows multiple users each with a keyboard, video, and mouse to access a single computer on a first come, first serve basis.

All connected keyboard, video and mice will act exactly as if they were connected directly to your computer. The MultiStation's sharing feature doesn't require any keyboard commands to use. The unit also splits the video signal allowing the same screen to be displayed on all monitors.

There are a variety of areas where you can use the MultiStation, such as point-of-sale, office collaboration, software development, CAD/CAM, production floor, conference room presentation, and many others. We know how our customers like to come up with new applications every day.

The MultiStation has a variety of other features to fine tune your application. Call us to find out how the MultiStation can simplify your computer access.



Typical Application

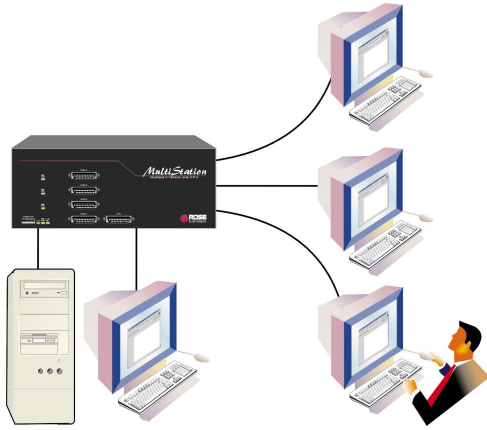

MultiStation Models The MultiStation units are available in three models. The standalone models support one computer to either two or four KVM stations. The distributed model allows you to have a local unit with one KVM and one CPU, and a remote unit with one KVM up to 250 feet apart.

Cables Rose's UltraCable streamlines the cable connections to MultiStation, simplifying cable management and improving system reliability. Order the computer or user cable by the computer's keyboard, monitor, and mouse connector style and desired length. We stock a large variety of cable types in lengths up to 100 feet. You should specify standard resolution (800x600 or less) or high resolution (greater than 800x600).

Installation MultiStation is easy to install. You simply connect your computer and keyboards, monitors, and mice to the MultiStation ports using the UltraCable. That's really all there is to it, sharing is automatic. The status LEDs on the front panel flash once a second to indicate KVM to KVM communication is active. Any activity of the keyboard and mouse will also cause the LEDs to flash.

Operation The MultiStation allows fully automatic sharing on a first-come, first-serve basis driving KVM signals up to 100 feet away. The default setting is that access to the computer from any keyboard and mouse is controlled by a timeout of two seconds. All monitors, should display the same screen. You should be able to type and move the mouse from any KVM. Wait two seconds for the timeout and you can access the computer from another KVM.

Enable, disable, freeze commands Enable, disable and freeze commands are used to further control access by stations. The commands themselves can be enabled or disabled on a per workstation basis by the front panel dip switches. The enable and disable commands allow you to control whether other KVM stations can have access to the computer. The disable disconnects the keyboard and mouse and turns the video off on all other stations. The enable restores all the stations. The freeze command is the same as the disable, but the video is not affected and remains on.

Keyboard and Mouse MultiStation provides adjustable keyboard typematic rate and delay on each station. It supports PC keyboard modes 1, 2, and 3, which means the MultiStation is compatible with all PCs, all IBM computers, and with Unix workstations. This is synchronized between all keyboards automatically. Also the Num/Caps/Scroll Lock LEDs on the keyboards are always synchronized. MultiStation supports both PS/2 and serial mouse. It can translate from PS/2 to serial or serial to PS/2 mouse

individually on each KVM station. You can adjust the sharing timeout interval. The default is two seconds, but you can program this up to 255 seconds. MultiStation provides automatic enabling of PS/2 mouse when its cable is reconnected. There is a keyboard and mouse reset command to re-initialize these devices. All programmable values only need to be programmed once, since they can be saved in non-volatile memory with the keep command.

Video MultiStation supports VGA video resolution up to 1280 x 1024 non-interlaced video. MultiStation allows you to display video to all KVMs simultaneously or to disable the video with the enable and disable commands. MultiStation provides an adjustable video blanking time interval to save wear and tear on the monitors.

Use with Rose switches All commands to the MultiStation are preceded by the right control key. This is designed to not interfere with commands used by Rose KVMs switches. The MultiStation can be used in conjunction with Rose KVM switches to provide optional local control in addition to the centralized control via the ServeView. This can be extended further to combine multiple ServeView switches to provide a matrix style system. For a full, non-blocking matrix system, please refer to the UltraMatrix product line data sheets.

Options To locate your computer, keyboard, monitor, or mouse further than 20 feet, use our coax high-resolution cables, ViewLink™ extenders, or CrystalView™ extenders to go as far as 1000 feet. Rack mount kits are available for 19", 23", or 24" racks.

Part Numbers

ML-2U	standalone unit with 2 KVMs and 1 CPU
ML-4U	standalone unit with 4 KVMs and 1 CPU
MLK-2U	distributed unit allows local unit with 1 KVM and 1 CPU and remote unit with 1 KVM up to 250' apart
RM-SV1/nn	MLK-2U / ML-2U rack mount kit, n=19", 23", 24"
RM-SV16/nn	ML-4U rack mount kit, n=19", 23", or 24"

Specifications

Dimensions	ML-2U / MLK-2U: 8.85" W x 4.90" D x 2.10" H 22.5 x 12.5 x 5.3 cm ML-4U: 13.10" W x 4.90" D x 5.25" H 33.3 x 12.5 x 13.3 cm.
Weight	ML-2U / MLK-2U: 3 lb. (1.8 kg.) ML-4U: 7 lb. (3.2 kg.)
AC Input Power	117 VAC Power Adapter supplied 230 VAC optional
Switch input power	17 VAC CT, 1.45 A
Connectors	Power: DIN5 CPU/KVM: DB25 Female Bus in/out: 13W3 Female (Model MLK-2U)
Rack mount option	19", 23", or 24"
Chassis	Fully shielded, black painted steel
Controls	Power On/Off Switch, 8-Position Dip Switch
Indicators	1 Power LED (green), Status LED (yellow), Remote Video LED (Yellow)
Environmental	0 to 55° C, 0-80% non-condensing rel. humidity



Rear view of MultiStation, models ML-2U and ML-4U

ROSE ELECTRONICS - US HEADQUARTERS

10707 Stancliff Road ■ Houston, Texas 77099 ■ USA
Tel 281-933-7673 ■ Tel 800-333-9343 ■ Fax 281-933-0044

ROSE ELECTRONICS - EUROPEAN OFFICE

Bourne Works High Street ■ Collingbourne Ducis
Marlborough Wiltshire SN8 3EH ■ UNITED KINGDOM
Tel +44 (0) 126 485 0574 ■ Fax +44 (0) 126 485 0529

ROSE ELECTRONICS - ASIA PACIFIC OFFICE

PO Box 3184 ■ Robina T.C. ■ Queensland 4230 ■ AUSTRALIA
Tel +617 5525 2714 ■ Fax +617 5525 2875

 **ROSE
ELECTRONICS**
WWW.ROSEL.COM